

WILO IL-E100/6-29BF PUMP



PRODUCT NO.: 20076

Serial no.: 20774706/0002

Brand: Wilo

kW: 20.2

Pump Type: Water

Electric or diesel: EL

CFM: 240 m³/h

Description

Wilo IL-E100/6-29BF - Art.-No. 2089714/1103 - 3-400V/50Hz/31.3A - 3-380V/60Hz/A - p1 20.2 kW - n/min 750 min - n/max 2960 min - max 240 m³/H - max lifting height 28 m.

Gallery

Energy-saving pumps
Single-head pumps in-line



Terminal Diagrams, Motor Data Wilo-CronoLine-IL-E... BF

Terminal diagram

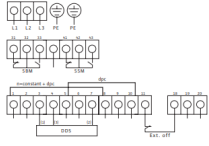

Switch rating of the interferences contacts for the collective Run and Fault signals:
Minimum 12 V DC / 10 mA, max. 250 V AC / 3 A.
1.2, 1.2.1, 1.3, RE.
Main connection 3~400 V / 50 Hz 3~380 V / 60 Hz
SSM: Potential-free collective fault signal
(Interference contact in accordance with VDI 3834, Function of: Wilo-TOP-Control)
SBM: Potential-free collective run signal
(Interference contact in accordance with VDI 3834, Function of: Wilo-TOP-Control)

Motor data

Wilo-CronoLine-IL-E...BF	Nominal power		Rotational speed		Power consumption		Current	
	P_2 [kW]	P_1 [kW]	n [rpm]	n_{max} [rpm]	P_1 [kW]	T_{max} [Nm]	I_{max} [A]	I_{nom} [A]
65/8-40	11.0	11.0	1180-2940	1180-2940	12.9	22.6	22.6	22.6
80/8-31	11.0	11.0	1180-2940	1180-2940	12.9	22.6	22.6	22.6
80/8-40	15.0	15.0	1180-2945	1180-2945	17.3	28.0	28.0	28.0
80/8-42	18.5	18.5	1180-2945	1180-2945	21.2	34.9	34.9	34.9
80/8-44	22.0	22.0	1180-2945	1180-2945	25.1	41.2	41.2	41.2
100/5-21	11.0	11.0	1180-2940	1180-2940	12.9	22.6	22.6	22.6
100/5-26	15.0	15.0	1180-2945	1180-2945	17.3	28.0	28.0	28.0
100/6-29	18.5	18.5	1180-2945	1180-2945	21.2	34.9	34.9	34.9
100/6-33	22.0	22.0	1180-2945	1180-2945	25.1	41.2	41.2	41.2

Three-phase motor (DM): 3-pole - 3~400 V, 50Hz / 3~380 V, 60 Hz
Note: motor type label data!

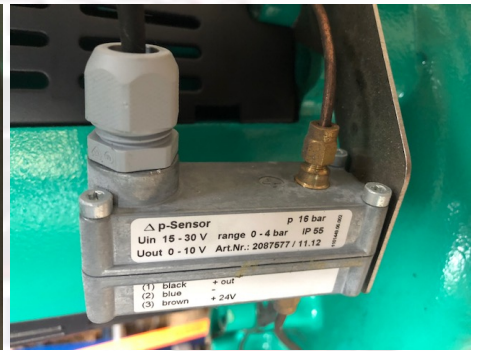

Wilo-IL-E 100 / 6-29 BF

Δp-c (constant)

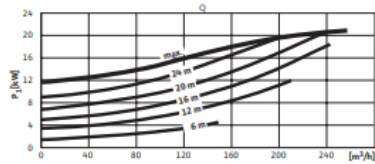
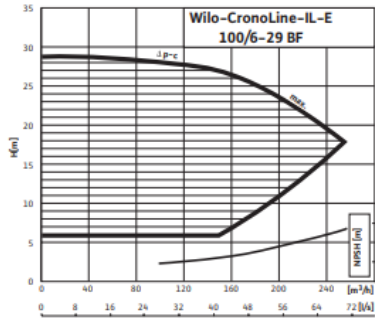

Energy-saving pumps

Single-head pumps in-line

Dimensions, Weights Wilo-CronoLine-IL-E... BF

Dimension drawing

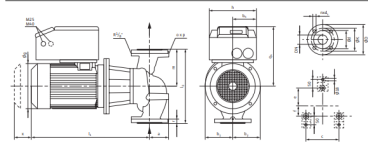

Wilo-CronoLine-IL-E...BF	Nominal diameter DN	Dimensions														Weight approximately [kg]			
		b ₁	b ₂	b ₃	b ₄	c	e	f	h	Ø s	Ø t	m	ø	p	q ₁		r	x	
65/8-40	65	430	110	126	146	199	180	195	60	387	312	830	235	M12	20	594	24	120	158
80/8-31	80	440	120	136	162	199	180	171	72	387	312	807	200	M12	20	594	24	120	167
80/8-40	80	440	120	136	162	199	180	171	72	387	312	807	200	M12	20	594	24	120	167
80/8-42	80	500	145	157	182	214	220	258	62	417	312	886	230	M12	20	599	24	120	184
80/8-44	80	500	145	157	182	214	220	258	62	417	312	924	230	M12	20	599	24	120	192
100/5-21	100	500	120	159	197	199	200	228	60	387	312	842	250	M12	20	594	24	135	182
100/5-26	100	500	120	159	197	199	200	228	60	387	312	842	250	M12	20	594	24	135	188
100/6-29	100	500	120	159	197	214	200	228	60	417	312	842	250	M12	20	599	24	135	192
100/6-33	100	500	120	159	197	214	200	228	60	417	312	957	250	M12	20	599	24	135	192

Wilo-CronoLine-IL-E...BF	Flange dimension		Pump flange dimensions			
	DN	Nominal diameter	Ø D	Ø d	Ø k	ø e, f
65...BF	65	185	118	118	145	ø +10
80...BF	80	200	132	160	160	ø +20
100...BF	100	220	156	180	180	ø +30

Flange dimension pump - in accordance with EN 2892-2/3 LK, ø = number of ball holes.

